



Chelsea Gate Apartments, Chelsea
London SW1W

GARTON JONES.COM



Chelsea Gate Apartments, Chelsea London, SW1W

GARTON JONES.COM

8 Gatliff Road
Grosvenor
Waterside
Chelsea
London
SW1W 8DP

Sales +44 (0) 20 7730 5007
gws@gartonjones.com
www.gartonjones.com

£850 Per Week

A spacious TWO DOUBLE BEDROOM apartment of approx. 788sq.ft (73sq.m) to rent. This small development is close to the River and opposite Chelsea Barracks. This FURNISHED property has a reception room, a separate kitchen, balcony, 2 bathrooms (1 en-suite) and built in wardrobes in the master bedroom. There is secure UNDERGROUND PARKING, 24 HOUR CONCEIRGE and an on-site residents' GYM.

Available via our office is on-site at Grosvenor Waterside (underneath Bramah House), approx. a 2 minute walk from the property. On-site Sainsbury's Local, coffee shop, and Purple Dragon private kids' club. Sloane Square and Victoria station with link to the Gatwick Express are within walking distance.

Please note the furniture may differ or not be included to that shown in current photos.

12 month minimum term
5 week deposit required

EPC Rating: C (75)

EPC certificate available on request.

- 788sq.ft (73.2Sq.m)
- 2 Double Bedrooms
- Bathroom Plus Separate Shower Room
- Reception Room
- Separate Kitchen with Integrated Appliances
- Private Balcony
- Secure Underground Parking
- 24 Hour Concierge
- Residents Gym & Spa
- Close to Shops, Bars, Restaurants & Transport Links



Chelsea gate

Approximate Gross Internal Area = 788 sq ft / 73.2 sq m

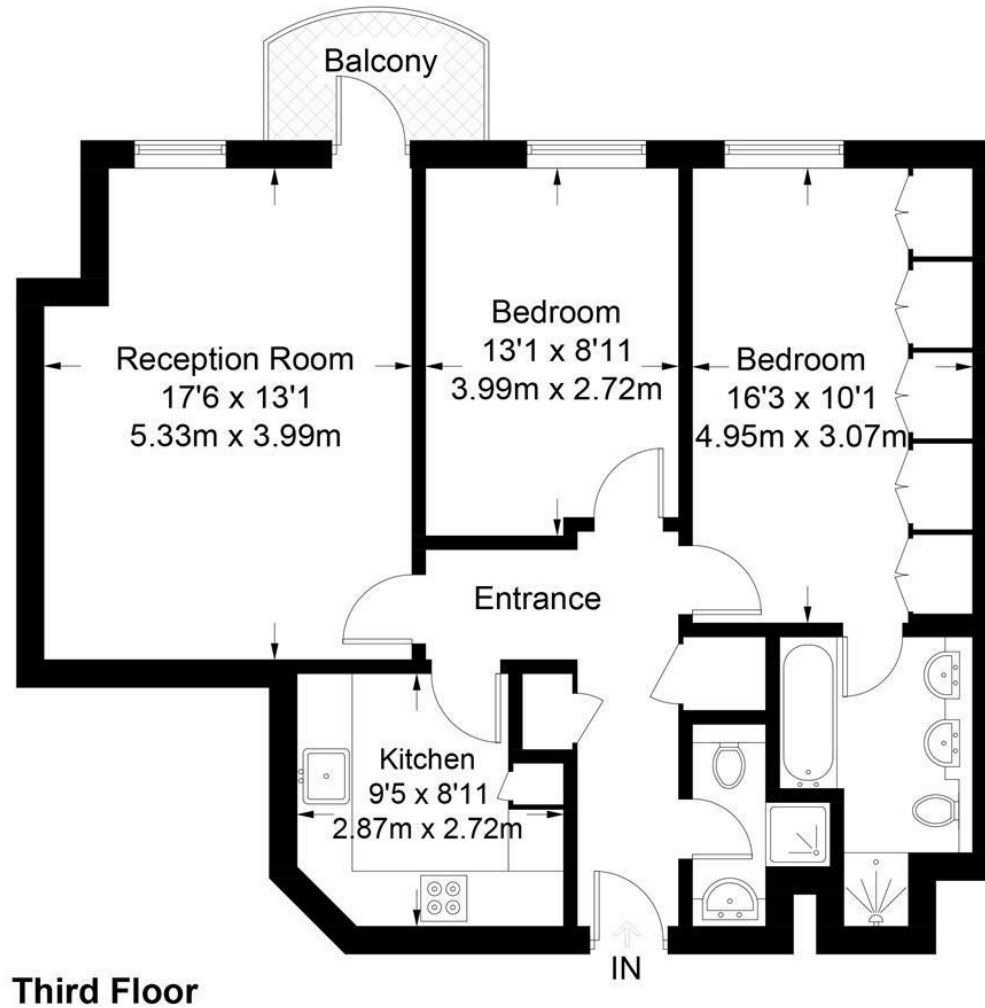

Third Floor

Not to scale, for guidance only and must not be relied upon as a statement of fact.
All measurements and areas are approximate only and have been prepared in accordance with the current edition of the RICS Code of Measuring Practice.

